

**GENERAL NOTES**

- The Contractor is responsible for the correct setting out of the buildings and all external and internal walls with particular reference to boundaries, building lines and setting out points.
- The Contractor is to verify all levels, heights and dimensions on site and is to check these against the drawing before putting any work in hand.
- The Contractor is to locate and identify existing services on the site and to protect these from damage throughout the duration of the contract.
- The Contractor is referred to the Standard Guidelines for Quality Control issued by this office for all minimum requirements for workmanship and materials. This document is to be used in conjunction with this drawing.
- Any errors, discrepancies or omissions are to be reported to the Architect immediately.
- Contractor is to build in Approved D.P.C.'s, whether or not these are shown on drawings, to all external walls of each floor, beam or parapet level and to all windows, doors, grilles or other opening in external walls. Cavity walls to have stepped D.P.C.'s.
- Any queries arising from all the above must be reported to the Architects for clarification before any work is put in hand.
- Do not scale this drawing; refer to figured dimensions only.

**REVISIONS**

NO.	DATE	DESCRIPTION	BY
01	31.5.19	Facebrick sections adjusted	AM
02	24.6.19	Walls adjusted and windows	AM
03	09.7.19	Walls adjusted and doors	AM

**PROJECT MANAGER:**  
**Delca Systems**  
 Development • Engineering • Logistics • Consulting Africa  
**DURBAN**  
 18 Westville Road, Westville 3630  
 Tel: (031) 266 5900, Fax: 031 266 5926  
 P.O. Box 370064, Overport 4067

**ARCHITECT:**  
**T2 DESIGN LAB**  
**JOHANNESBURG**  
 1751 Eastwood Crescent, Noordwyk  
 Tel: (011) 070 8688, Fax: 086 763 6360  
 P.O. Box 897, North Riding 2162  
**PIETERMARITZBURG**  
 Office 6, MG House, 134 Jobu Ndlovu St.  
 Tel: (033) 345 3191, Fax: 086 763 6360  
 P.O. Box 151, Maudslayi 3231  
 Email: info@t2designlab.co.za  
 Cell: 076 870 5744/079 494 8586

**CLIENT**  
**DANNHAUSER LOCAL MUNICIPALITY**

**PROJECT DESCRIPTION**  
**PROPOSED NEW OFFICES**  
**FOR**  
**DANNHAUSER MUNICIPALITY**  
**PROJECT LOCATION**  
**DANNHAUSER**  
**KWAZULU NATAL**

**DRAWING DESCRIPTION**  
**GROUND FLOOR PLAN**  
**BRICKWORK SETTING OUT**

**SCALE** 1:100 | **SHEET SIZE** A1 | **DATE** 09-07-2019

**DRAWN BY** AM | **CHECKED BY** TM | **SIGNED:**

**DRAWING STATUS**  
 PRELIM. MUNICIPAL TENDER CONSTR.

**PROJECT No.** 1505 | **DISCIPLINE** A | **DRAWING No.** 206 | **REVISION** 03  
**DRAWING NUMBER** 1505-206

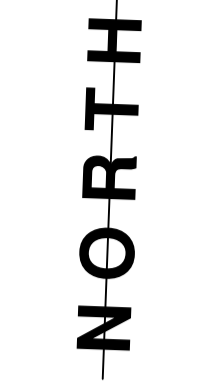
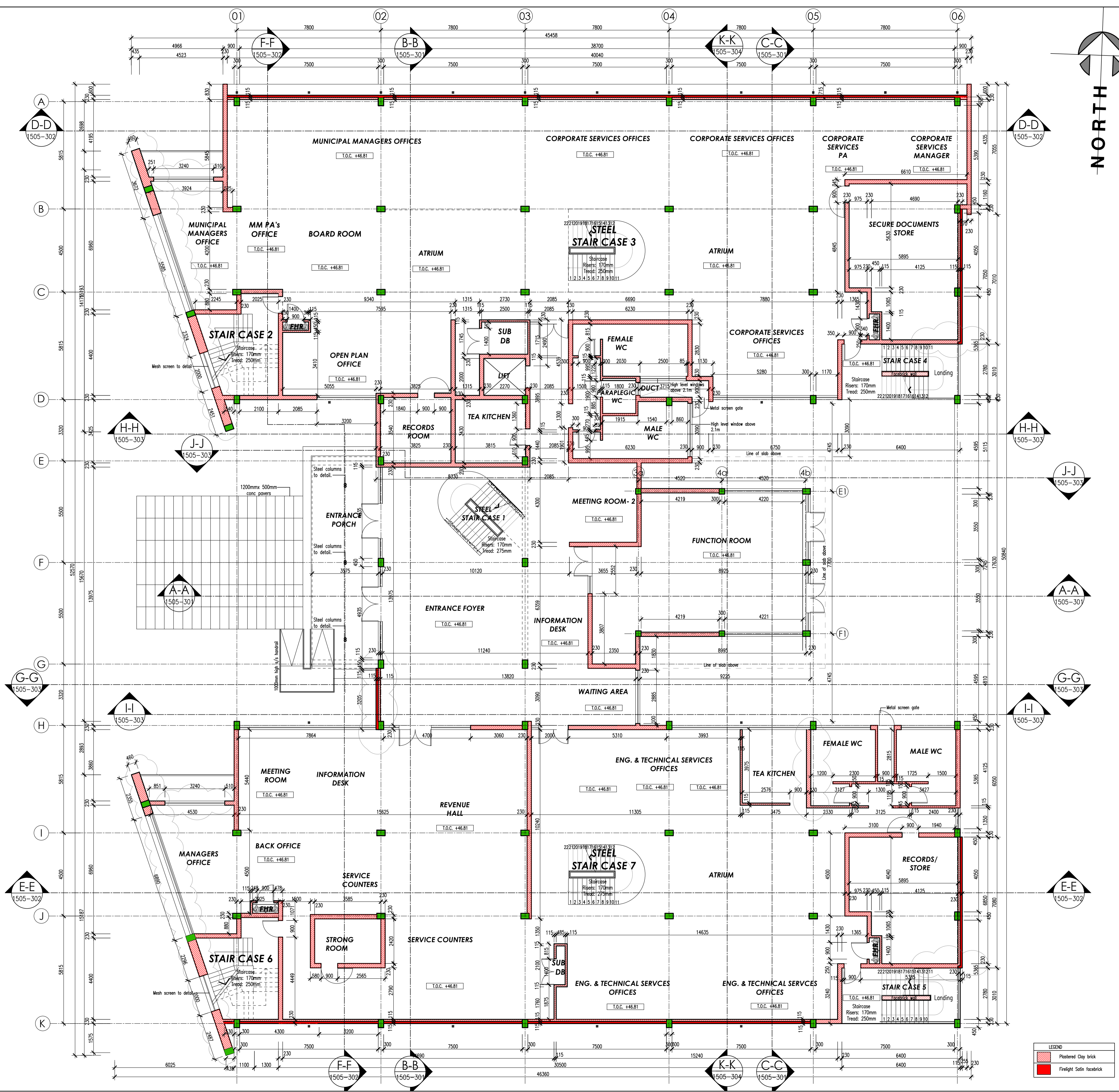

**LEGEND**  
 Plastered Clay Brick  
 Firefight Slatin Facebrick