

GENERAL NOTES

1. The Contractor is responsible for the correct setting out of the buildings and all external and internal walls with particular reference to boundaries, building lines and setting out points.
2. The Contractor is to verify all levels, heights and dimensions on site and is to check these against the drawing before putting any work in hand.
3. The Contractor is to locate and identify existing services on the site and to protect these from damage throughout the duration of the contract.
4. The Contractor is referred to the Standard Guidelines for Quality Control issued by this office for all minimum requirements for workmanship and materials. This document is to be used in conjunction with this drawing.
5. Any errors, discrepancies or omissions are to be reported to the Architect immediately.
6. Contractor is to build in Approved D.P.C.'s, whether or not these are shown on drawings, to all external walls of each floor, beam or parapet level and to all windows, doors, grilles or other opening in external walls. Cavity walls to have stepped D.P.C.'s.
7. Any queries arising from all the above must be reported to the Architects for clarification before any work is put in hand.
8. Do not scale this drawing; refer to figured dimensions only.

REVISIONS

| NO. | DATE | DESCRIPTION | BY |
|-----|---------|--------------------------------|----|
| 01 | 11.9.18 | Adjustments to column. | TM |
| 02 | 05.2.19 | Revisions to Doors and windows | AM |
| 02 | 09.5.19 | Revisions to steel mesh | AM |
| | | | |
| | | | |
| | | | |
| | | | |
| | | | |
| | | | |
| | | | |
| | | | |
| | | | |
| | | | |
| | | | |
| | | | |
| | | | |
| | | | |
| | | | |
| | | | |
| | | | |
| | | | |
| | | | |
| | | | |
| | | | |

PROJECT MANAGER:

Development • Engineering • Logistics • Consulting Africa

DURBAN
 18 Westville Road, Westville 3630
 Tel: (031) 266 5900, Fax: 031 266 5926
 P.O. Box 370064, Overport 4067

ARCHITECT:

JOHANNESBURG
 1751 Easternwood Crescent, Noordryk
 Tel: (011) 070 8688, Fax: 086 763 6360
 P.O. Box 897, North Riding 2162

PIETERMARITZBURG
 Office 6, MG House, 134 Jobu Ndlovu St.
 Tel: (0333) 345 3191, Fax: 086 763 6360
 P.O. Box 151, Masundazi 3231
 Email: info@t2designlab.co.za
 Cell: 076 870 5744/079 494 8586

CLIENT
DANNHAUSER LOCAL MUNICIPALITY

PROJECT DESCRIPTION
**PROPOSED NEW OFFICES
 FOR
 DANNHAUSER MUNICIPALITY**

PROJECT LOCATION
**DANNHAUSER
 KWAZULU NATAL**

DRAWING DESCRIPTION
LOWER GROUND FLOOR PLAN

| SCALE | SHEET SIZE | DATE |
|----------|------------|------------|
| 1:100 | A1 | 05-02-2019 |
| DRAWN BY | CHECKED BY | SIGNED: |
| TM | TM | |

DRAWING STATUS

PRELIM. MUNICIPAL TENDER CONSTR.

| PROJECT No. | DISCIPLINE | DRAWING No. | REVISION |
|----------------|------------|-------------|----------|
| 1505 | A | 201 | 03 |
| DRAWING NUMBER | | 1505-201 | |

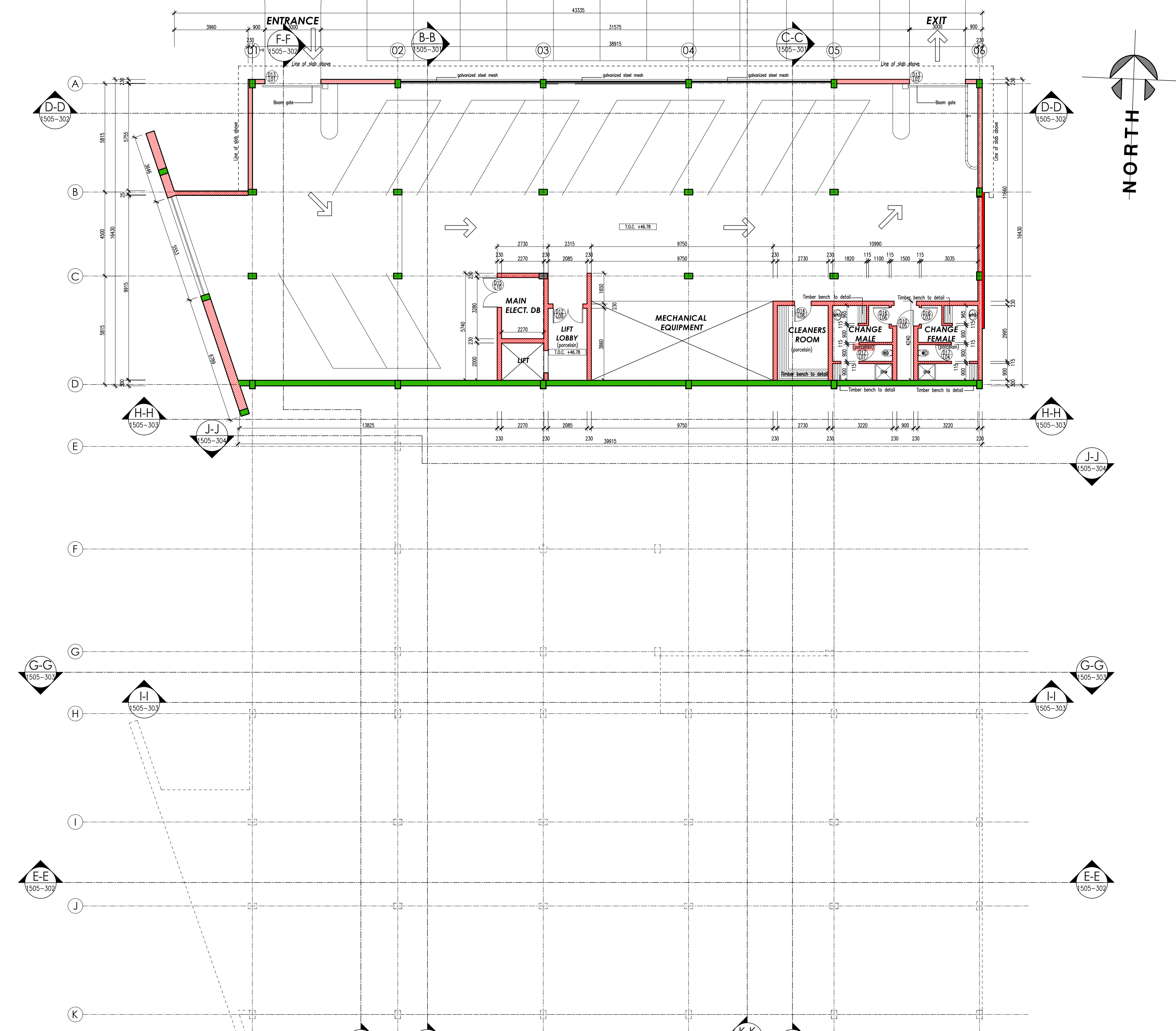

LOWER GROUND FLOOR PLAN
 SCALE 1:100